

NON LOAD BEARING SLAB

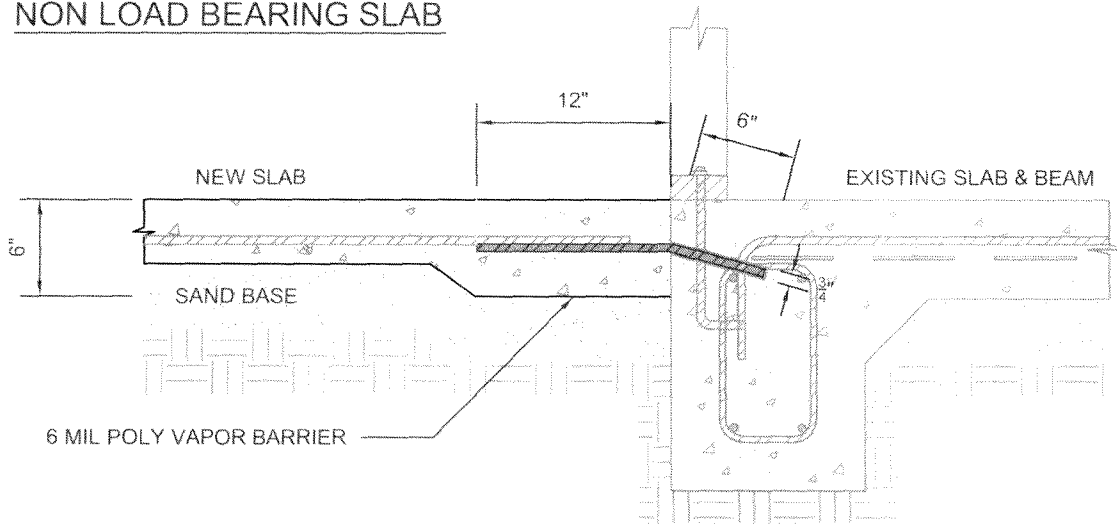

NEW SLAB BEARING A WALL

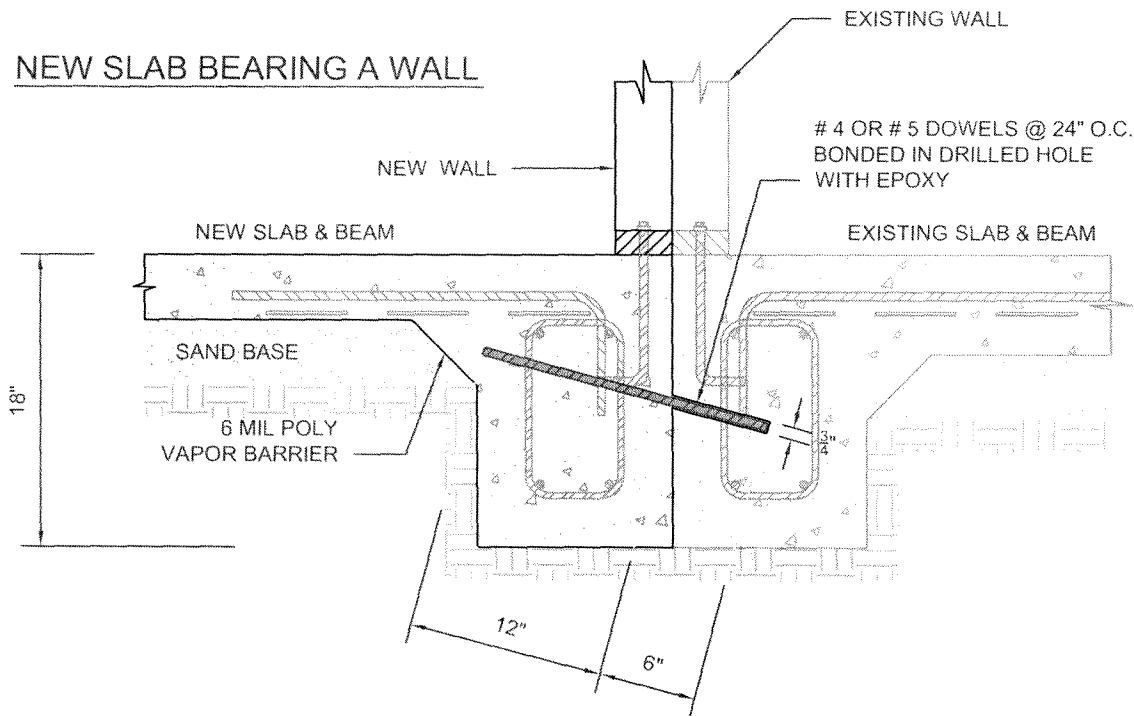

GENERAL NOTES:

1. Clean holes with oil free, moisture free compressed air.
2. Holes and dowels shall be dry and free of dust, dirt, grease, oil and any other foreign contaminants.
3. Allow epoxy to harden before placing concrete.
4. Place bars a minimum of 2" from exposed surfaces.
5. Use # 4 or # 5 dowels @ 24" o.c.
6. Hole depth and diameter are as per the epoxy manufacturer's recommendations (otherwise 6" deep and 1/4" larger than bar diameter).

<p>CITY OF HOUSTON Department of Public Works and Engineering</p>		
<p>RESIDENTIAL CONCRETE BONDING DETAIL</p>		
<p>Approved by:</p> <p style="text-align: center;"><i>Mark J. Lock</i> Building Official</p>		
DATE: 4 / 13 / 10	DWG No: 10-06-R	1 of 1