

PLAN

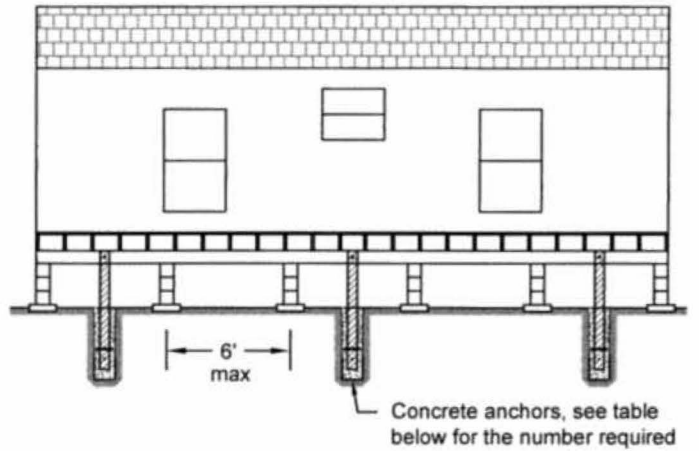

ELEVATION

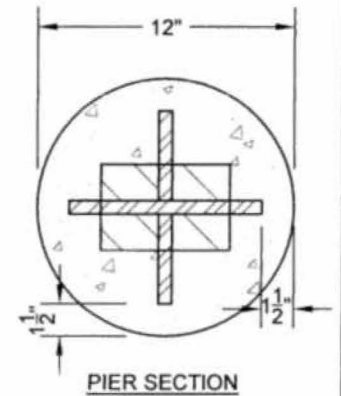
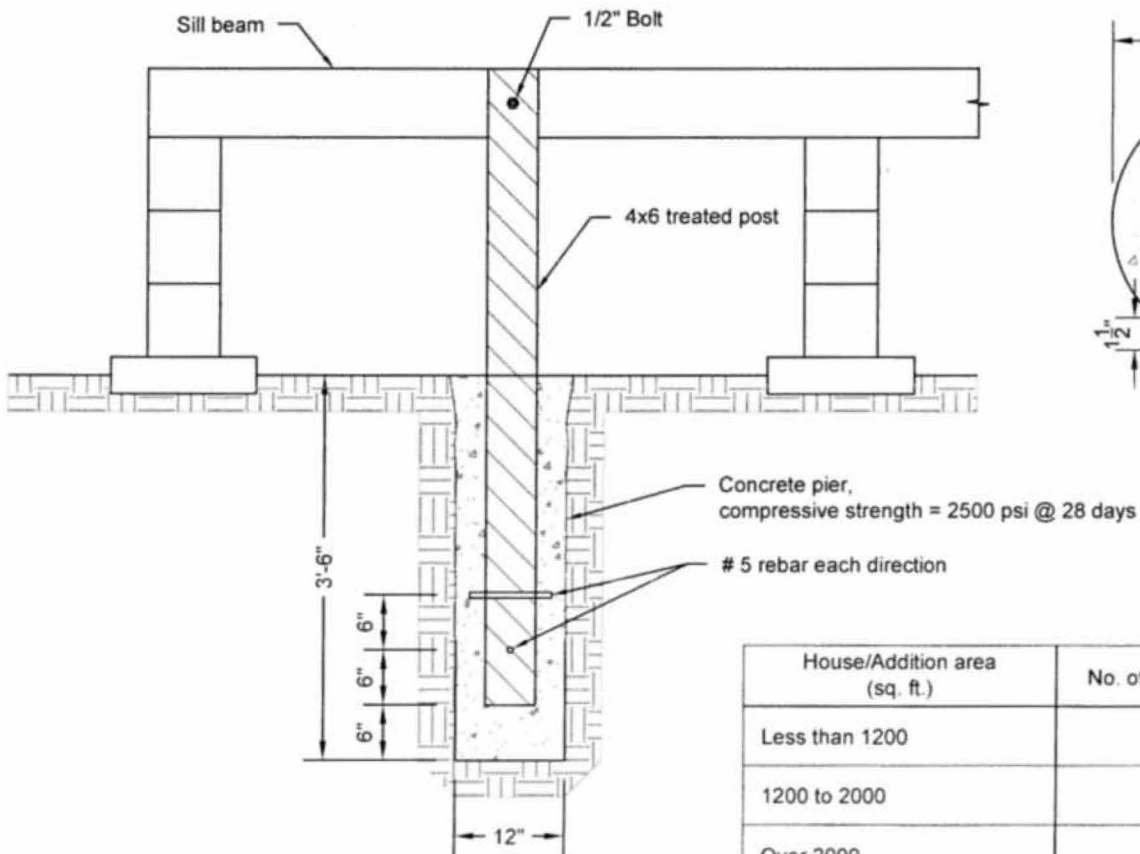

House/Addition area (sq. ft.)	No. of anchors required
Less than 1200	4
1200 to 2000	6
Over 2000	8

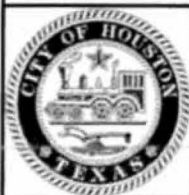

STANDARD DRAWING

**CITY OF HOUSTON**  
DEPARTMENT OF PUBLIC  
WORKS & ENGINEERING

HOUSE ANCHORING DETAILS

1002 WASHINGTON AVE., HOUSTON, TEXAS 77002

APPROVED BY *Tom Foley*  
BUILDING OFFICIAL  
APPROVED BY *[Signature]*  
CITY ENGINEER

DATE:  
12 / 18 / 2014

DWG No:  
14-05-R