

INSULATION & FENESTRATION REQUIREMENTS				
CLIMATE ZONE	FENESTRATION U-FACTOR	FENESTRATION SHGC	CEILING R-VALUE	WOOD FRAME WALL R-VALUE
2	0.40 (MAX)	0.25 (MAX)	38 (MIN)	13 (MIN)

For roof slopes of 4:12 or greater, 1 layer of 15 LB felt
 For roof slopes from 2:12 to 4:12, 2 layers of 15 LB felt
 For roof slopes under 2:12, asphalt shingles are not allowed

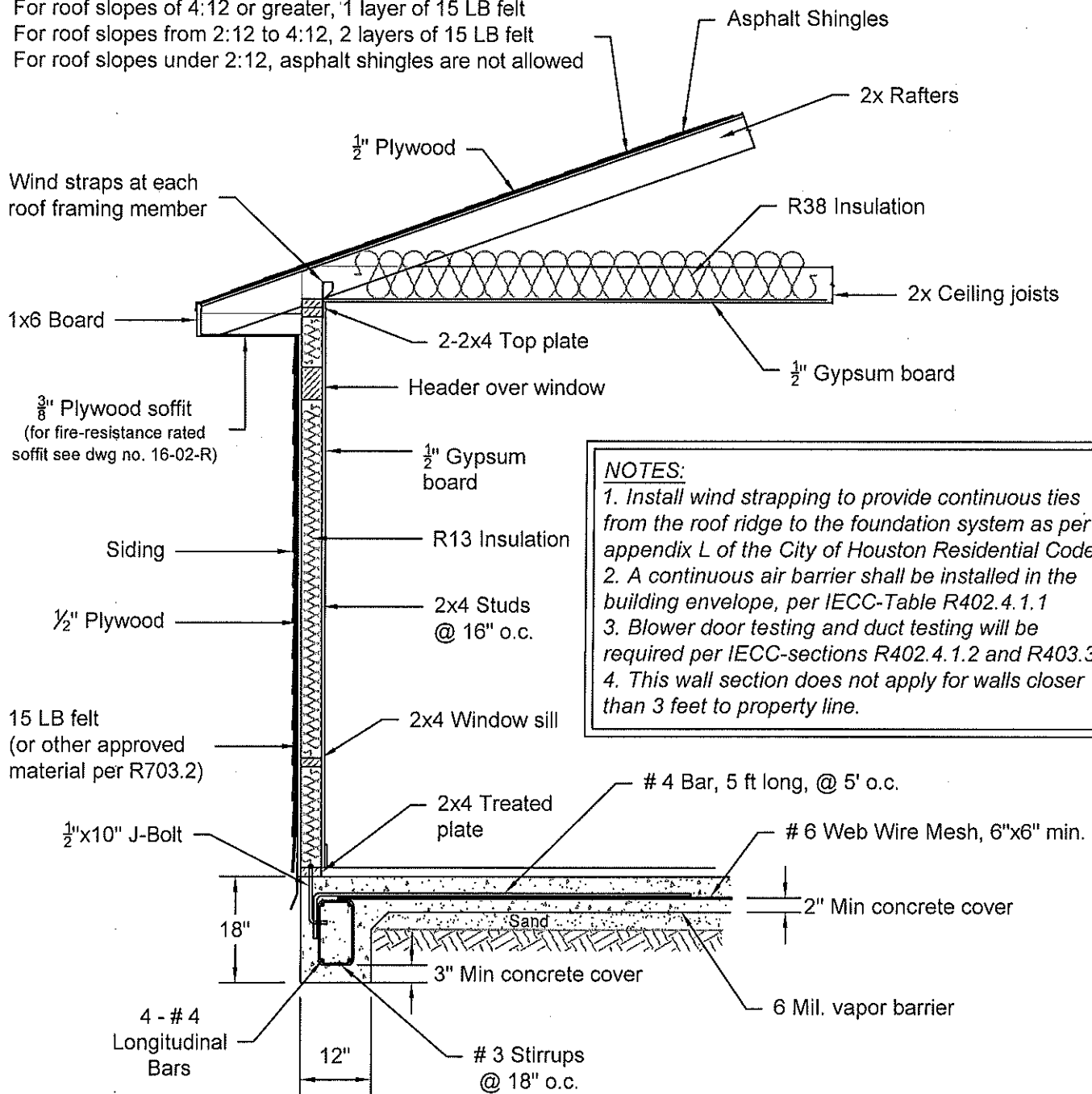

NOTES:
 1. Install wind strapping to provide continuous ties from the roof ridge to the foundation system as per appendix L of the City of Houston Residential Code
 2. A continuous air barrier shall be installed in the building envelope, per IECC-Table R402.4.1.1
 3. Blower door testing and duct testing will be required per IECC-sections R402.4.1.2 and R403.3.3
 4. This wall section does not apply for walls closer than 3 feet to property line.



STANDARD DRAWING
 CITY OF HOUSTON
 HOUSTON PUBLIC WORKS
 BUILDING CODE ENFORCEMENT

RESIDENTIAL NON FIRE RATED
 WALL SECTION
 (ONE STORY - SIDING)
 1002 WASHINGTON AVE., HOUSTON, TEXAS 77002

APPROVED BY:
Mah Lant
 BUILDING OFFICIAL
 DATE: 10/11/2018 DWG No: 18-12-R 1 of 1